

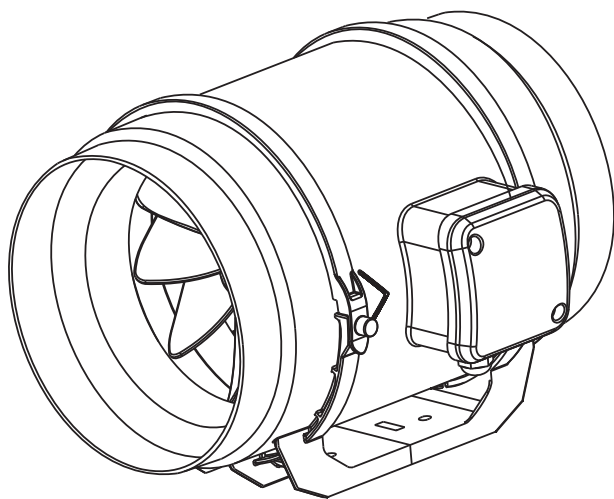

OPERATING MANUAL

Mixed Flow Inline Fan



UK
CA | CE

FAN OVERVIEW

The AIR EC range of fans are optimised for high pressure, low noise and large air movement. Their design offers the flexibility to remove the fan blades and motor from the mount whilst the ductwork remains in place.

DIMENSIONS

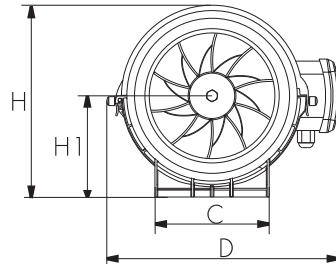
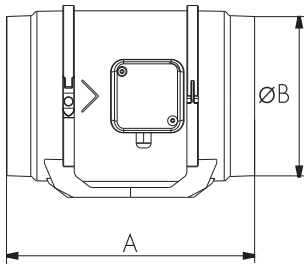

Product	A mm	øB mm	C mm	D mm	H mm	H1 mm
AIR 100 EC	300	100	100	214	225	95
AIR 125 EC	300	100	100	214	225	95
AIR 150-160 EC	293	150	120	237	252	110
AIR 200 EC	304	200	140	258	279	124
AIR 250 EC	383	250	180	298	310	152

SPECIFICATIONS

220-240 Volts AC 50Hz

Product	Power (W)	Max. air flow (m ³ /h)	Max. static pressure (Pa)	Noise (dB)	Duct size (ømm)	Net weight (kg)
AIR 100 EC	20	200	180	30	100/125	1.8
AIR 125 EC	20	200	180	30	100/125	1.8
AIR150-160 EC	35	500	300	35	150/160	2.2
AIR 200 EC	55	850	350	50	200	3.1
AIR 250 EC	140	1500	550	60	250	7.0

INSTALLATION

When using the mount to secure the fan please use the following steps. Hanging and securing the fan can also be achieved via alternative methods such as rope ratchets or jack chains.

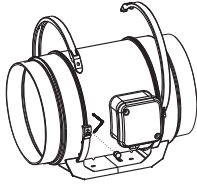

1. Undo the buckle screw and the buckle.

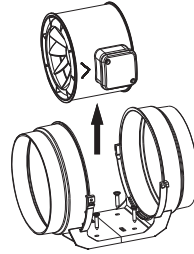

2. Remove the fan from the bracket and mount.

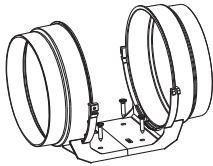

3. Secure the mount with screws in your desired location.

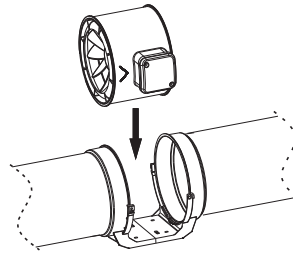

4. Connect your ducting to the mount and refit the fan.

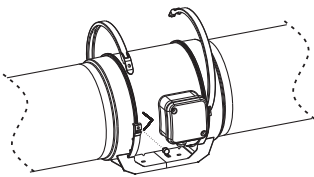

5. Secure the fan with the buckles and fix in place with the screws.

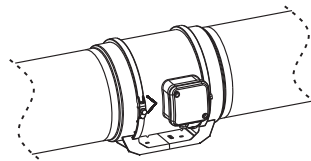

6. Your fan and ductwork is now sealed and secure and ready to use.

CONTROLLING THE FAN

The fan will run at 100% if no controller is connected. Air EC fans are compatible with the range of EC controllers available from G.A.S. Each controller connects directly to the 3 pin EC cable located on the fan.

PRESSURE CURVES

Key
— Fan pressure curve
- - - Max. air flow & pressure
— Filter pressure drop

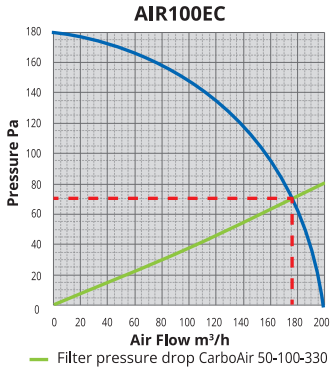

Product	Max. air flow	Max. air flow with filter
AIR 100 EC	200 m ³ /h	175 m ³ /h

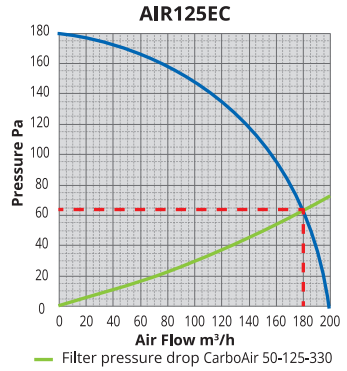

Product	Max. air flow	Max. air flow with filter
AIR 125 EC	200 m ³ /h	180 m ³ /h

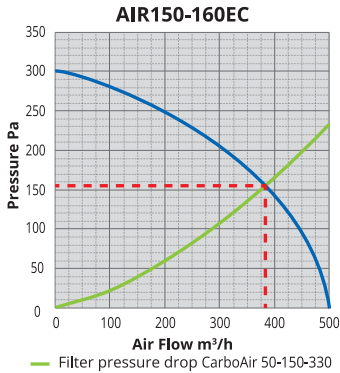

Product	Max. air flow	Max. air flow with filter
AIR 150-160 EC	500 m ³ /h	390 m ³ /h

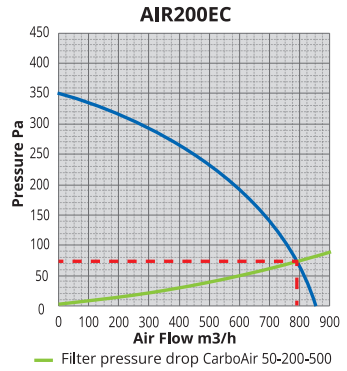

Product	Max. air flow	Max. air flow with filter
AIR 200 EC	850 m ³ /h	790 m ³ /h

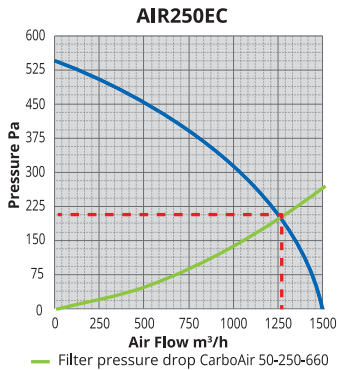

Product	Max. air flow	Max. air flow with filter
AIR 250 EC	1500 m ³ /h	1250 m ³ /h